



Table with top made of solid wood, consisting of two single planks aligned, with middle gap and natural sides. Upon request available with asymmetrical planks, disaligned of 30 cm (Bedrock Plank B). Base in iron plate characterised by geometric lines.

STANDARD VERSION: NATURAL IRON BASE, MATT TRANSPARENT LACQUERED (B2); ALIGNED PLANKS. SAME PRICE FOR DISALIGNED PLANKS (BEDROCK PLANK B), TOP OVERALL LENGTH +30 CM THAN SIZES INDICATED IN THE PRICELIST

CODE	SIZE	A1	A2	A3	A4	A5
BEDROCK-PLANK 1.DIR	W.220 x D.90/100 x H.76	■	■	■	■	■
BEDROCK-PLANK 2.DIR	W.240 x D.90/100 x H.76	■	■	■	■	■
BEDROCK-PLANK 3.DIR	W.260 x D.90/100 x H.76	■	■	■	■	■
BEDROCK-PLANK 4.DIR	W.280 x D.90/100 x H.76	■	■	■	■	■
BEDROCK-PLANK 5.DIR	W.300 x D.90/100 x H.76	■	■	■	■	■

- AVAILABLE FINISHES:**
A1: walnut with knots
A2: oak with knots
A3: oak with knots finish: whitened, mystic black, vintage, neutro
A4: oak with knots pigmented: ash grey, white milk, total black
A5: oak: flamed london, with knots vulcano, with knots tabacco

FEASIBILITY LACQUERED IRON BASE	
B2	■
B3	■

- AVAILABLE FINISHES:**
B2: lacquered iron: matt transparent, irondust, RAL (only selected colours)
B3: lacquered iron matt brushed effect: aged copper, aged bronze, stainless steel, titanium
lacquered iron oxidised effect

BEDROCK-PLANK C

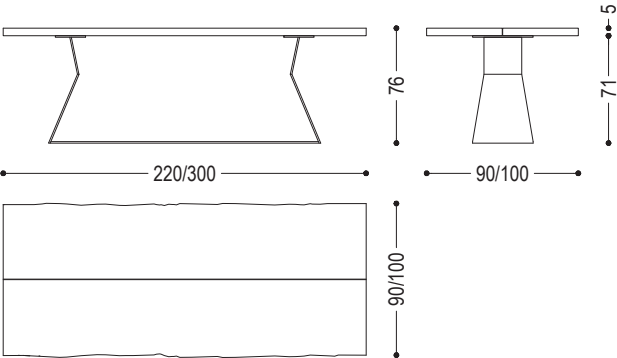

BEDROCK-PLANK B

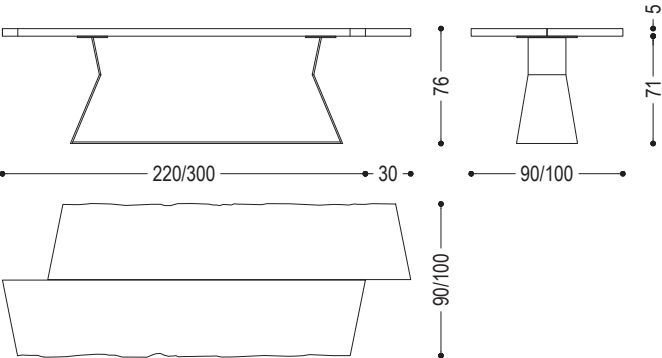

WOOD

A1



walnut with knots

A2



oak with knots

A3



oak with knots finish:
whitened

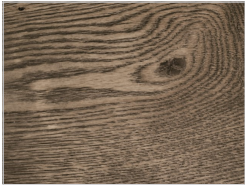

oak with knots finish:
mystic black



oak with knots finish:
vintage



oak with knots finish:
neutro

A4



oak with knots pigmented:
ash grey



oak with knots pigmented:
white milk



oak with knots pigmented:
total black

A5



oak:
flamed london



oak:
with knots vulcano



oak:
with knots tabacco

IRON

B2					
	lacquered iron: matt transparent	lacquered iron: irondust			
					
	ferro laccato: RAL - 1013_OYSTER WHITE	ferro laccato: RAL - 3020_TRAFFIC RED	ferro laccato: RAL - 7035_LIGHT GREY	ferro laccato: RAL - 7037_DUSTY GREY	ferro laccato: RAL - 8019_GREY BROWN
					
	ferro laccato: RAL - 9001_CREAM WHITE	ferro laccato: RAL - 9002_GREY WHITE	ferro laccato: RAL - 9005_JET BLACK	ferro laccato: RAL - 9010_PURE WHITE	ferro laccato: RAL - 9016_TRAFFIC WHITE
B3					
	lacquered iron, matt brushed effect: aged copper	lacquered iron, matt brushed effect: aged bronze	lacquered iron, matt brushed effect: stainless steel	lacquered iron, matt brushed effect: titanium	lacquered iron, oxidised effect